

[ELETTRONICA TIRRITO SRL]

Via San Leone 169 - 94100 Enna EN

P.Iva 01228470868

Elettronica Tirrito S.r.l.

Led Lighting

SETTABLE DRIVER

E' vietata la riproduzione. Tutti i diritti sono riservati.

Nessuna parte della presente può essere riprodotta o diffusa con qualsiasi mezzo, fotocopie, microfilm o altro, senza il consenso scritto di Elettronica Tirrito s.r.l.

Copyrights by Elettronica Tirrito s.r.l. All rights reserved.

No part of this may be reproduced in any form, by Photostat, microfilm, xerography or any other means, or incorporated into any information retrieval system, electronic or mechanical, without the written permission of the copyright owner. All the inquires should be addressed to Elettronica Tirrito s.r.l.



UB. ES. e L.C.D.F. e Sede legale: Via San Leone 169 - 94100 Enna (EN)

Tel. 0935 1865109 Fax 0935 1866109

e-mail: amministrazione@elettronica-tirrito.it Pec: eletronicatirritosrl@pec.it Internet: www.elettronica-tirrito.it

P.Iva 01228470868 Reg. imprese 69911

E-mail: amministrazione@elettronica-tirrito.it

progettazione@elettronica-tirrito.it

Web site: www.elettronica-tirrito.it

Overvoltage protection

In contrast to other lamps, light-emitting diodes (LEDs) are only designed for low operating voltages and they are therefore more sensitive to overvoltage. This also applies for the required electronic control gear (LED drivers).

This can have a variety of consequences: Partial or complete failure of the LED module; Faster aging of the LED module and thus reduced service life; Failure of the LED driver; Failure of the control interfaces.

To protect our light fixtures we use drivers provided with the sufficient protection to contrast an overload up to 10KV.

Overvoltage is when the rated voltage of the network is exceeded significantly. There can be different causes of overvoltage and it can be triggered by different events:

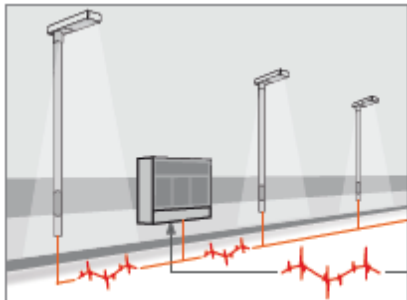

**Switching operations
or load change on the
power grid**

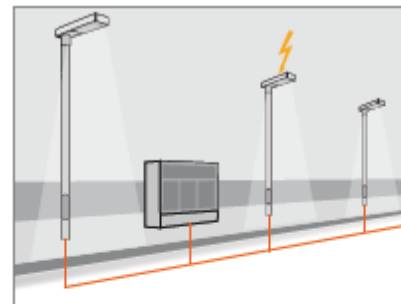

**Lightning strikes directly on
the streetlights**

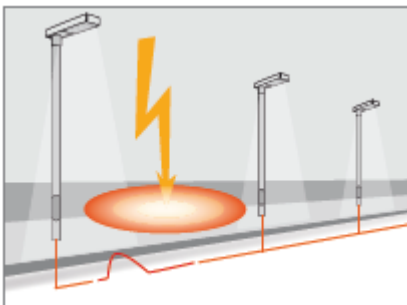

**Lighting strikes
nearby**

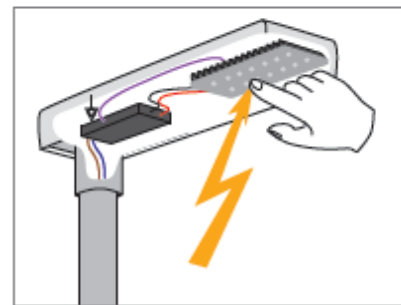

Electrostatic discharge

Regional differences

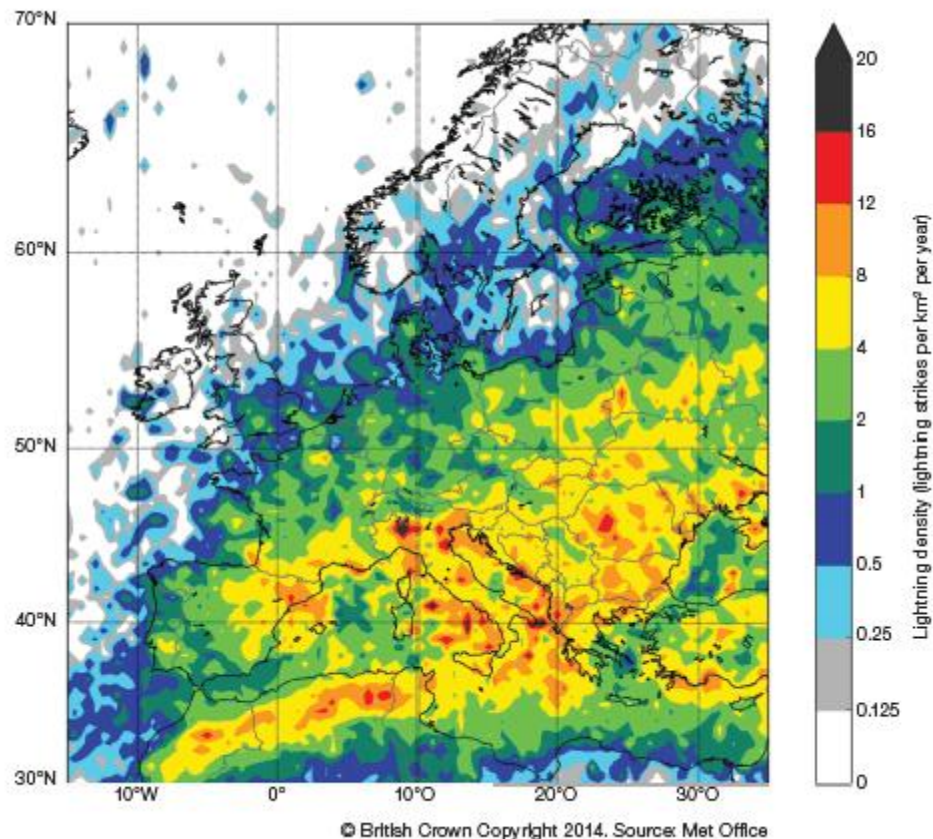

The graphic describes the european regional areas most interested by the overloads which increase during the hot summer months.

Our drivers are integrated with an above average protection to ensure the maximum possible protection.

Dimming modes

Every driver used in our street lights is dimmable with the following systems:

DALI



Thanks to the DALI interface, our drivers can be integrated in the telemetry systems and it is possible to communicate in bidirectional mode and also to control the lamp status.

0-10V



Analogic Dimmer: Input 0-10V for the light dimming from 0% to 100% after the voltage application, it can be integrated in the telemetry systems.

StepDIM/StepDIM inverse



External System Dimming with customizable levels.

CLO (constant lumen output)



The luminous flux reduction can be compensated during the lifetime of the LED module thanks to a programmed voltage to ensure a stable lighting by reducing energy costs and while increasing its lifetime.

AstroDIM/presence detection



Automatic dimming based on an internal automatic timer, five independent levels can be setted and also five zones. It is recommended to combine this system with an external sensor.

Fit for SMART GRID



It is possible to monitor the energy consumption and the activity hours. The benefits are a better lighting analysis while ensuring a safe functioning of the system.

MainsDIM



Dimming based on the different present capability on the line. This type of control system matches perfectly with the existent flux reducers.

Integrated overvoltage protection



Overload protection up to 6kV in differential mode and 8kV in common mode and up to 10kV in common mode for single impulse.



**ELETRONICA TIRRITO S.R.L.
THANKS YOU FOR YOUR INTEREST,
HOPING TO HAVE FOUND THE PERFECT SOLUTION
TO YOUR REQUEST.**

FOR INFOS

WEBSITE: www.elettronica-tirrito.it

ADDRESS: ENNA - VIA SAN LEONE, 169

CONTACT US: 0935/1865109; amministrazione@elettronica-tirrito.it